

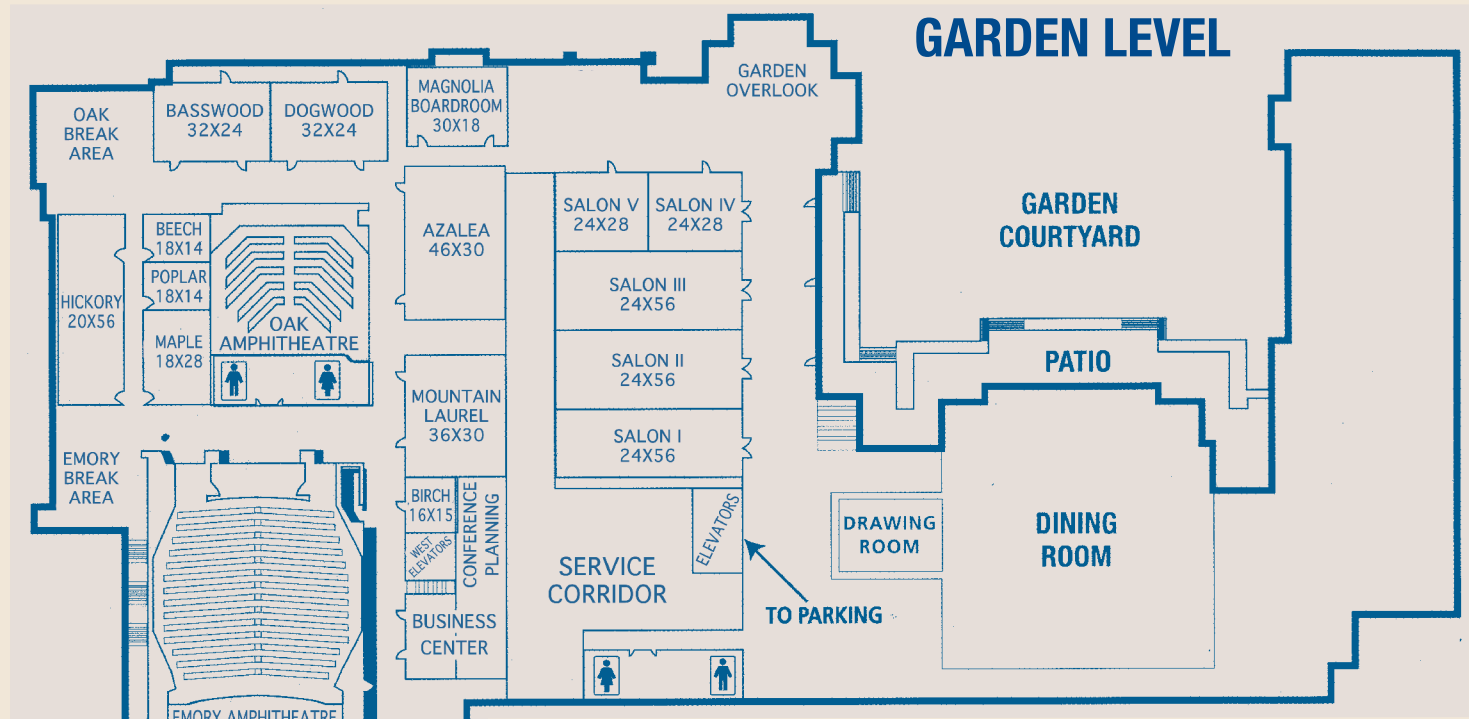

# MEETING SPACE FACILITIES FLOOR SPECIFICATIONS

## GARDEN LEVEL



## SOUTH WING

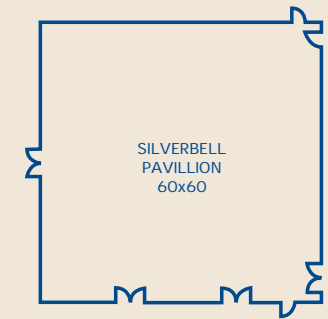
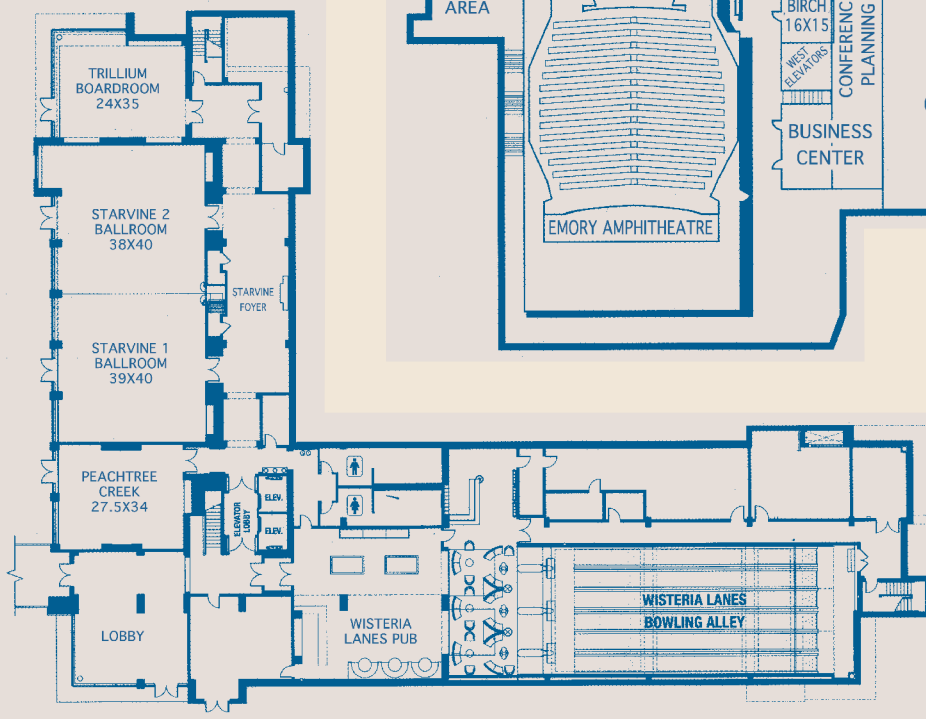

\*Diagram is not to scale. Please refer to capacities chart for dimensions.



# MEETING SPACE FACILITIES CAPACITIES CHART

| ROOM NAME                | CEILING HEIGHT | SQUARE FEET | ROOM SIZE   | THEATER | CLASSROOM | U-SHAPE | BANQUET | CONFERENCE | RECEPTION |
|--------------------------|----------------|-------------|-------------|---------|-----------|---------|---------|------------|-----------|
| Emory Amphitheater       |                | 4,680       | 65' X 72'   |         | 240       |         |         |            |           |
| Oak Amphitheater         |                | 1,920       | 40' X 48'   |         | 74        |         |         |            |           |
| Azalea                   | 11'            | 1,380       | 46' X 30'   | 100/60  | 60/80     | 36/42   | 100     | 40/48      | 140       |
| Hickory                  | 11'            | 1,120       | 20' X 56'   | 80/100  | 56/70     | 34/42   | 90      | 40/46      | 120       |
| Mountain Laurel          | 11'            | 1,080       | 36' X 30'   | 70/120  | 32/60     | 26/32   | 80      | 28/32      | 115       |
| Basswood                 | 11'            | 768         | 32' X 24'   | 50/65   | 28/42     | 20/24   | 50      | 24/28      | 75        |
| Dogwood                  | 11'            | 768         | 32' X 24'   | 50/65   | 28/42     | 20/24   | 50      | 24/28      | 75        |
| Maple                    | 11'            | 504         | 18' X 28'   | 20/32   | 16/28     | 12/18   | 30      | 16/20      |           |
| Beech                    | 11'            | 252         | 18' X 14'   | 12/16   | 8/16      |         |         | 10/12      |           |
| Poplar                   | 11'            | 252         | 18' X 14'   | 12/16   | 8/16      |         |         | 10/12      |           |
| Birch                    | 11'            | 240         | 16' X 15'   | 12/16   | 8/16      |         |         | 10/12      |           |
| Magnolia                 | 8'             | 540         | 30' X 18'   |         |           |         |         | 14         |           |
| Lullwater Ballroom       |                | 5,376       | 96' X 56'   | 700     | 170/350   |         | 400     |            | 600       |
| Salon 1                  | 14'-16'        | 1,344       | 24' X 56'   | 100/150 | 68/90     | 32/38   | 100     | 34/46      | 140       |
| Salon 2                  | 14'-16'        | 1,344       | 24' X 56'   | 100/150 | 68/90     | 32/38   | 100     | 34/46      | 140       |
| Salon 3                  | 14'-16'        | 1,344       | 24' X 56'   | 100/150 | 68/90     | 32/38   | 100     | 34/46      | 140       |
| Salon 4                  | 14'            | 672         | 24' X 28'   | 50/80   | 30/38     | 16/28   | 50      | 20/26      | 70        |
| Salon 5                  | 14'            | 672         | 24' X 28'   | 50/80   | 30/38     | 16/32   | 50      | 20/26      | 70        |
| The Silverbell Pavillion | 24'            | 3,600       | 60' X 60'   | 320     | 120       |         | 200     |            | 300       |
| Trillium Boardroom       | 12'            | 816         | 24' X 35'   |         |           |         |         | 20         |           |
| Peachtree Creek          | 12'            | 907         | 27.5' X 34' | 50      | 27        | 26/30   | 40      | 22/26      |           |
| Starvine Ballroom        | 11.6'-13.6'    | 3,048       | 77' X 40'   | 200     | 120/150   | 46/52   | 180     | 26/32      | 250       |
| Starvine 1               | 11.6'-13.6'    | 1,544       | 39' X 40'   | 100     | 60/75     | 30/36   | 90      | 26/32      | 120       |
| Starvine 2               | 11.6'-13.6'    | 1,504       | 38' X 40'   | 100     | 60/75     | 30/36   | 90      | 26/32      | 120       |
| The Garden Overlook      | 30'            | 1,296       | 36' X 36'   |         |           |         | 80      |            | 200       |
| The Emory Break Area     | 30'            | 900         | 30' X 30'   |         |           |         | 50      |            | 100       |
| The Oak Break Area       | 30'            | 900         | 30' X 30'   |         |           |         | 50      |            | 100       |
| Starvine Foyer           | 11'6"          | 884         | 52' X 17'   |         |           |         |         |            | 120       |
| Wisteria Lanes           |                |             |             |         |           |         |         |            | 120       |